

MAISON D'OR

SOUTH FLAGLER

Residence
A1
Level 4

3 Bedrooms | Den | 4.5 Bathrooms

Interior 4,141 SF
Terraces 693 SF
Total 4,834 SF

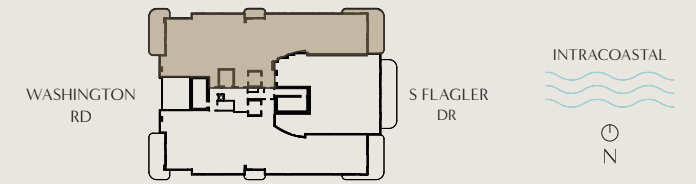

© Broker Participation Welcomed and Encouraged. ORAL REPRESENTATIONS CANNOT BE RELIED UPON AS CORRECTLY STATING REPRESENTATIONS OF THE SELLER. FOR CORRECT REPRESENTATIONS, MAKE REFERENCE TO THIS BROCHURE AND TO THE DOCUMENTS REQUIRED BY SECTION 718.503, FLORIDA STATUTES, TO BE FURNISHED BY A SELLER TO A BUYER OR LESSEE. This project has been filed in the state of Florida and no other state. This is not an offer to sell or solicitation of offers to buy the condominium units in states where such offer or solicitation cannot be made. Prices and availability are subject to change at any time without notice. All dimensions are approximate and all floorplans and development plans are subject to change. There are various methods for calculating the total square footage of a condominium unit, and depending on the method of calculation, the quoted square footage of a condominium unit may vary by more than a nominal amount. The total condominium unit square footages as shown in this brochure are based on the "Architectural Method" of measurement and the exterior perimeter measurements of the condominium unit, which include exterior walls, interior columns and fifty percent of demising walls. These square footage calculations are higher than the interior area space calculations for the condominium units. Please see the Declaration of Condominium for more information.

Sales Gallery
3014 S Dixie Highway, West Palm Beach, FL 33405
T 561.273.7900
LiveMaisonDOr.com | info@LiveMaisonDOr.com

KOLTERURBAN
PERKO MAISON D'OR
REALTY, LLC



MAISON D'OR

SOUTH FLAGLER

Residence
A
 Levels 5-14

3 Bedrooms | Den | 4.5 Bathrooms

Interior 4,353 SF
 Terraces 693 SF
 Total 5,046 SF

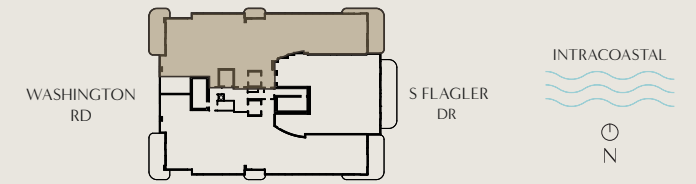

© Broker Participation Welcomed and Encouraged. ORAL REPRESENTATIONS CANNOT BE RELIED UPON AS CORRECTLY STATING REPRESENTATIONS OF THE SELLER. FOR CORRECT REPRESENTATIONS, MAKE REFERENCE TO THIS BROCHURE AND TO THE DOCUMENTS REQUIRED BY SECTION 718.503, FLORIDA STATUTES, TO BE FURNISHED BY A SELLER TO A BUYER OR LESSEE. This project has been filed in the state of Florida and no other state. This is not an offer to sell or solicitation of offers to buy the condominium units in states where such offer or solicitation cannot be made. Prices and availability are subject to change at any time without notice. All dimensions are approximate and all floorplans and development plans are subject to change. There are various methods for calculating the total square footage of a condominium unit, and depending on the method of calculation, the quoted square footage of a condominium unit may vary by more than a nominal amount. The total condominium unit square footages as shown in this brochure are based on the "Architectural Method" of measurement and the exterior perimeter measurements of the condominium unit, which include exterior walls, interior columns and fifty percent of demising walls. These square footage calculations are higher than the interior area space calculations for the condominium units. Please see the Declaration of Condominium for more information.

Sales Gallery
 3014 S Dixie Highway, West Palm Beach, FL 33405
 T 561.273.7900
 LiveMaisonDOr.com | info@LiveMaisonDOr.com

KOLTERURBAN
 PERKO MAISON D'OR
 REALTY, LLC



MAISON D'OR

SOUTH FLAGLER

Residence
B
Levels 4-14

2 Bedrooms | Den | 3 Bathrooms

Interior 2,991 SF
Terraces 420 SF
Total 3,411 SF

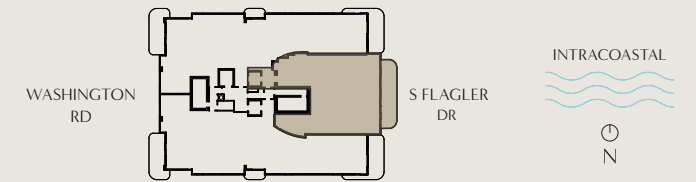

© Broker Participation Welcomed and Encouraged. ORAL REPRESENTATIONS CANNOT BE RELIED UPON AS CORRECTLY STATING REPRESENTATIONS OF THE SELLER. FOR CORRECT REPRESENTATIONS, MAKE REFERENCE TO THIS BROCHURE AND TO THE DOCUMENTS REQUIRED BY SECTION 718.503, FLORIDA STATUTES, TO BE FURNISHED BY A SELLER TO A BUYER OR LESSEE. This project has been filed in the state of Florida and no other state. This is not an offer to sell or solicitation of offers to buy the condominium units in states where such offer or solicitation cannot be made. Prices and availability are subject to change at any time without notice. All dimensions are approximate and all floorplans and development plans are subject to change. There are various methods for calculating the total square footage of a condominium unit, and depending on the method of calculation, the quoted square footage of a condominium unit may vary by more than a nominal amount. The total condominium unit square footages as shown in this brochure are based on the "Architectural Method" of measurement and the exterior perimeter measurements of the condominium unit, which include exterior walls, interior columns and fifty percent of demising walls. These square footage calculations are higher than the interior area space calculations for the condominium units. Please see the Declaration of Condominium for more information.

Sales Gallery
3014 S Dixie Highway, West Palm Beach, FL 33405
T 561.273.7900
LiveMaisonDOr.com | info@LiveMaisonDOr.com

KOLTERURBAN
PERKO MAISON D'OR
REALTY, LLC



MAISON D'OR

SOUTH FLAGLER

Residence
C1
Level 4

3 Bedrooms | Den | 4.5 Bathrooms

Interior 4,230 SF
Terraces 693 SF
Total 4,923 SF

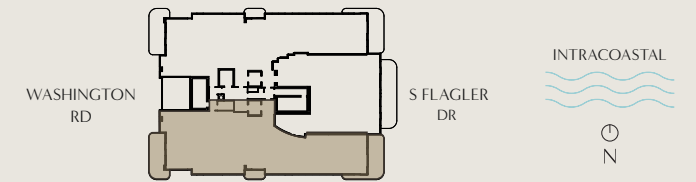

© Broker Participation Welcomed and Encouraged. ORAL REPRESENTATIONS CANNOT BE RELIED UPON AS CORRECTLY STATING REPRESENTATIONS OF THE SELLER. FOR CORRECT REPRESENTATIONS, MAKE REFERENCE TO THIS BROCHURE AND TO THE DOCUMENTS REQUIRED BY SECTION 718.503, FLORIDA STATUTES, TO BE FURNISHED BY A SELLER TO A BUYER OR LESSEE. This project has been filed in the state of Florida and no other state. This is not an offer to sell or solicitation of offers to buy the condominium units in states where such offer or solicitation cannot be made. Prices and availability are subject to change at any time without notice. All dimensions are approximate and all floorplans and development plans are subject to change. There are various methods for calculating the total square footage of a condominium unit, and depending on the method of calculation, the quoted square footage of a condominium unit may vary by more than a nominal amount. The total condominium unit square footages as shown in this brochure are based on the "Architectural Method" of measurement and the exterior perimeter measurements of the condominium unit, which include exterior walls, interior columns and fifty percent of demising walls. These square footage calculations are higher than the interior area space calculations for the condominium units. Please see the Declaration of Condominium for more information.

Sales Gallery
3014 S Dixie Highway, West Palm Beach, FL 33405
T 561.273.7900
LiveMaisonDOr.com | info@LiveMaisonDOr.com

KOLTERURBAN
PERKO MAISON D'OR
DEVELOPMENT PARTNERS REALTY, LLC



MAISON D'OR

SOUTH FLAGLER

Estate
A
Levels 15-17

4 Bedrooms | Den | 5.5 Bathrooms

Interior 5,922 SF
Terraces 1,133 SF
Total 7,055 SF

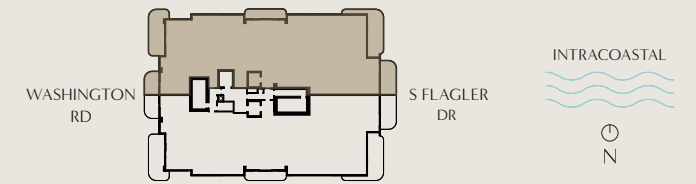

© Broker Participation Welcomed and Encouraged. ORAL REPRESENTATIONS CANNOT BE RELIED UPON AS CORRECTLY STATING REPRESENTATIONS OF THE SELLER. FOR CORRECT REPRESENTATIONS, MAKE REFERENCE TO THIS BROCHURE AND TO THE DOCUMENTS REQUIRED BY SECTION 718.503, FLORIDA STATUTES, TO BE FURNISHED BY A SELLER TO A BUYER OR LESSEE. This project has been filed in the state of Florida and no other state. This is not an offer to sell or solicitation of offers to buy the condominium units in states where such offer or solicitation cannot be made. Prices and availability are subject to change at any time without notice. All dimensions are approximate and all floorplans and development plans are subject to change. There are various methods for calculating the total square footage of a condominium unit, and depending on the method of calculation, the quoted square footage of a condominium unit may vary by more than a nominal amount. The total condominium unit square footages as shown in this brochure are based on the "Architectural Method" of measurement and the exterior perimeter measurements of the condominium unit, which include exterior walls, interior columns and fifty percent of demising walls. These square footage calculations are higher than the interior area space calculations for the condominium units. Please see the Declaration of Condominium for more information.

Sales Gallery
3014 S Dixie Highway, West Palm Beach, FL 33405
T 561.273.7900
LiveMaisonDOr.com | info@LiveMaisonDOr.com

KOLTERURBAN
PERKO MAISON D'OR
DEVELOPMENT PARTNERS REALTY, LLC



MAISON D'OR

SOUTH FLAGLER

Estate
B
Levels 15-17

4 Bedrooms | Den | 5.5 Bathrooms

Interior 5,739 SF
Terraces 1,133 SF
Total 6,872 SF

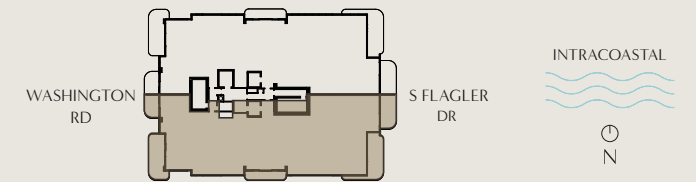

© Broker Participation Welcomed and Encouraged. ORAL REPRESENTATIONS CANNOT BE RELIED UPON AS CORRECTLY STATING REPRESENTATIONS OF THE SELLER. FOR CORRECT REPRESENTATIONS, MAKE REFERENCE TO THIS BROCHURE AND TO THE DOCUMENTS REQUIRED BY SECTION 718.503, FLORIDA STATUTES, TO BE FURNISHED BY A SELLER TO A BUYER OR LESSEE. This project has been filed in the state of Florida and no other state. This is not an offer to sell or solicitation of offers to buy the condominium units in states where such offer or solicitation cannot be made. Prices and availability are subject to change at any time without notice. All dimensions are approximate and all floorplans and development plans are subject to change. There are various methods for calculating the total square footage of a condominium unit, and depending on the method of calculation, the quoted square footage of a condominium unit may vary by more than a nominal amount. The total condominium unit square footages as shown in this brochure are based on the "Architectural Method" of measurement and the exterior perimeter measurements of the condominium unit, which include exterior walls, interior columns and fifty percent of demising walls. These square footage calculations are higher than the interior area space calculations for the condominium units. Please see the Declaration of Condominium for more information.

Sales Gallery
3014 S Dixie Highway, West Palm Beach, FL 33405
T 561.273.7900
LiveMaisonDOr.com | info@LiveMaisonDOr.com

KOLTERURBAN
PERKO MAISON D'OR
DEVELOPMENT PARTNERS REALTY, LLC



MAISON D'OR

SOUTH FLAGLER

Penthouse
LPH A
 Level 18

4 Bedrooms | Den | 5.5 Bathrooms

Interior 5,922 SF
 Terraces 1,133 SF
 Total 7,055 SF

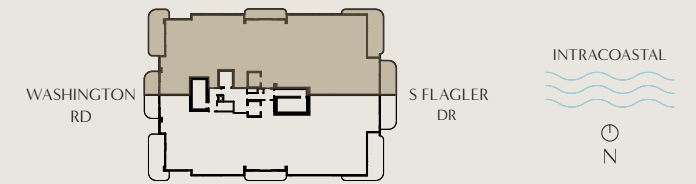

© Broker Participation Welcomed and Encouraged. ORAL REPRESENTATIONS CANNOT BE RELIED UPON AS CORRECTLY STATING REPRESENTATIONS OF THE SELLER. FOR CORRECT REPRESENTATIONS, MAKE REFERENCE TO THIS BROCHURE AND TO THE DOCUMENTS REQUIRED BY SECTION 718.503, FLORIDA STATUTES, TO BE FURNISHED BY A SELLER TO A BUYER OR LESSEE. This project has been filed in the state of Florida and no other state. This is not an offer to sell or solicitation of offers to buy the condominium units in states where such offer or solicitation cannot be made. Prices and availability are subject to change at any time without notice. All dimensions are approximate and all floorplans and development plans are subject to change. There are various methods for calculating the total square footage of a condominium unit, and depending on the method of calculation, the quoted square footage of a condominium unit may vary by more than a nominal amount. The total condominium unit square footages as shown in this brochure are based on the "Architectural Method" of measurement and the exterior perimeter measurements of the condominium unit, which include exterior walls, interior columns and fifty percent of demising walls. These square footage calculations are higher than the interior area space calculations for the condominium units. Please see the Declaration of Condominium for more information.

Sales Gallery
 3014 S Dixie Highway, West Palm Beach, FL 33405
 T 561.273.7900
 LiveMaisonDOr.com | info@LiveMaisonDOr.com

KOLTERURBAN
 PERKO MAISON D'OR
 REALTY, LLC



MAISON D'OR

SOUTH FLAGLER

Penthouse
LPH B
 Level 18

4 Bedrooms | Den | 5.5 Bathrooms

Interior 5,739 SF
 Terraces 1,133 SF
 Total 6,872 SF

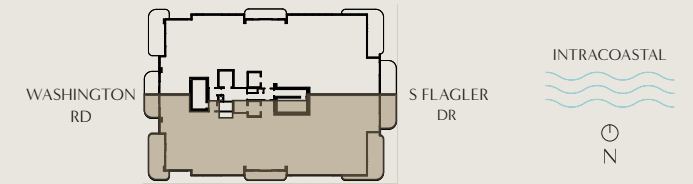

© Broker Participation Welcomed and Encouraged. ORAL REPRESENTATIONS CANNOT BE RELIED UPON AS CORRECTLY STATING REPRESENTATIONS OF THE SELLER. FOR CORRECT REPRESENTATIONS, MAKE REFERENCE TO THIS BROCHURE AND TO THE DOCUMENTS REQUIRED BY SECTION 718.503, FLORIDA STATUTES, TO BE FURNISHED BY A SELLER TO A BUYER OR LESSEE. This project has been filed in the state of Florida and no other state. This is not an offer to sell or solicitation of offers to buy the condominium units in states where such offer or solicitation cannot be made. Prices and availability are subject to change at any time without notice. All dimensions are approximate and all floorplans and development plans are subject to change. There are various methods for calculating the total square footage of a condominium unit, and depending on the method of calculation, the quoted square footage of a condominium unit may vary by more than a nominal amount. The total condominium unit square footages as shown in this brochure are based on the "Architectural Method" of measurement and the exterior perimeter measurements of the condominium unit, which include exterior walls, interior columns and fifty percent of demising walls. These square footage calculations are higher than the interior area space calculations for the condominium units. Please see the Declaration of Condominium for more information.

Sales Gallery
 3014 S Dixie Highway, West Palm Beach, FL 33405
 T 561.273.7900
 LiveMaisonDOr.com | info@LiveMaisonDOr.com

KOLTERURBAN
 PERKO MAISON D'OR
 REALTY, LLC



MAISON D'OR

SOUTH FLAGLER

Residence
C
 Levels 5-14

3 Bedrooms | Den | 4.5 Bathrooms

Interior 4,430 SF
 Terraces 693 SF
 Total 5,123 SF

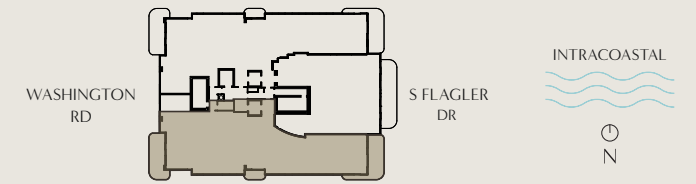

© Broker Participation Welcomed and Encouraged. ORAL REPRESENTATIONS CANNOT BE RELIED UPON AS CORRECTLY STATING REPRESENTATIONS OF THE SELLER. FOR CORRECT REPRESENTATIONS, MAKE REFERENCE TO THIS BROCHURE AND TO THE DOCUMENTS REQUIRED BY SECTION 718.503, FLORIDA STATUTES, TO BE FURNISHED BY A SELLER TO A BUYER OR LESSEE. This project has been filed in the state of Florida and no other state. This is not an offer to sell or solicitation of offers to buy the condominium units in states where such offer or solicitation cannot be made. Prices and availability are subject to change at any time without notice. All dimensions are approximate and all floorplans and development plans are subject to change. There are various methods for calculating the total square footage of a condominium unit, and depending on the method of calculation, the quoted square footage of a condominium unit may vary by more than a nominal amount. The total condominium unit square footages as shown in this brochure are based on the "Architectural Method" of measurement and the exterior perimeter measurements of the condominium unit, which include exterior walls, interior columns and fifty percent of demising walls. These square footage calculations are higher than the interior area space calculations for the condominium units. Please see the Declaration of Condominium for more information.

Sales Gallery
 3014 S Dixie Highway, West Palm Beach, FL 33405
 T 561.273.7900
 LiveMaisonDOr.com | info@LiveMaisonDOr.com

KOLTERURBAN
 PERKO MAISON D'OR
 DEVELOPMENT PARTNERS REALTY, LLC



